

61330M Printhead Assembly Maintenance Kit

Installation Instructions

This kit includes the parts and documentation necessary to install the printhead assembly in the HC100™. Read these instructions thoroughly before installing this kit.

Prepare for Installation

Parts List

Before proceeding, verify that your kit contains the items for your printer listed below.

✓	Item	Qty	Part Number	Description
	Ref	1	61330M	2 in. Thermal Printhead Maintenance Kit
	1	1	<i>61259-12</i>	2 in. Thermal Printhead
	2	1	<i>61248</i>	Media Chute
	3	1	<i>61230</i>	Printhead Lever Plate

Bold = Part available for purchase.
Italic = Part not available for purchase; listed and shown for reference only.

Figure 3 • Kit Contents

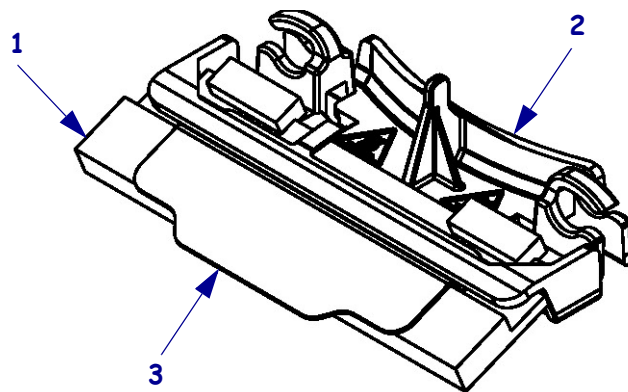

Tools Required



Tools • You need these tools to complete this procedure:

- Antistatic Wriststrap and Mat
- 47362* Zebra Preventive Maintenance Kit

* In place of the Preventive Maintenance Kit, you may use a clean swab dipped in a solution of isopropyl alcohol (minimum 90%) and deionized water (maximum 10%).

Remove the Media Cartridge

1. See [Figure 4](#). Press Eject and remove the media cartridge.

Figure 4 • Media Cartridge, Eject Button, and HC100

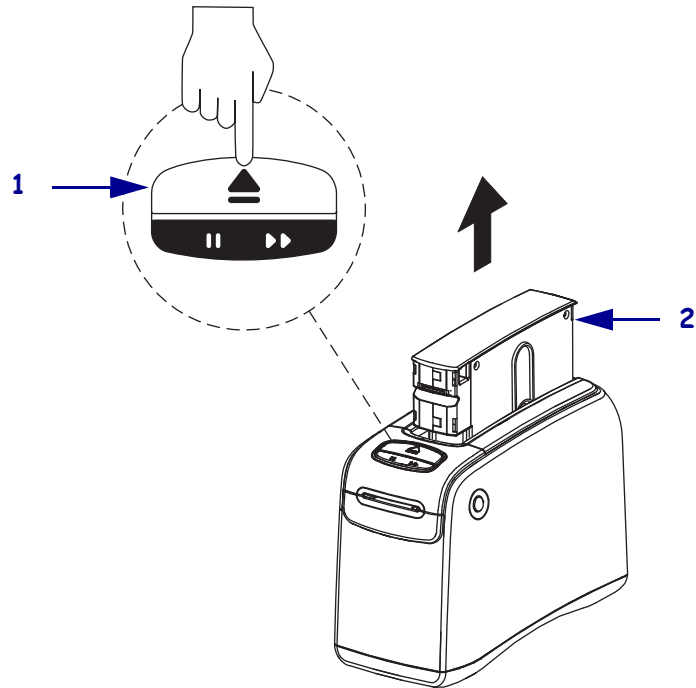

1	Eject button
2	Media cartridge

2. Did the cartridge eject?

If...	Then...
Yes	<ol style="list-style-type: none"> Remove the media cartridge and set aside. Go to Open the Printer on page 23.
No	<ol style="list-style-type: none"> Turn off (O) the power switch. Turn on (I) the power and wait for the printer to power up completely. Press Eject. Continue with step 3.

3. Did the cartridge eject this time?

If...	Then...
Yes	a. Remove the media cartridge and set aside. b. Go to <i>Open the Printer</i> .
No	a. Turn off (O) the power switch. b. Turn on (I) the power and wait for the printer to power up completely. c. Press and hold Eject for six seconds. d. Release Eject. e. If the cartridge ejected, go to <i>Open the Printer</i> . f. If the cartridge did not eject, continue with step 4 .

4. Contact Technical Support. See *Contacts* on page 9.

Open the Printer



1. **Caution** • Observe proper electrostatic safety precautions when handling static-sensitive components such as circuit boards and printheads.

Connect yourself to an antistatic device.

2. Place the printer on the antistatic mat.



3. **Caution** • Turn off (O) the printer before performing the following procedure.

Turn off (O) the printer.

4. See [Figure 5](#). Press the upper cover release buttons located on both sides of the printer.

Figure 5 • Opening the HC100

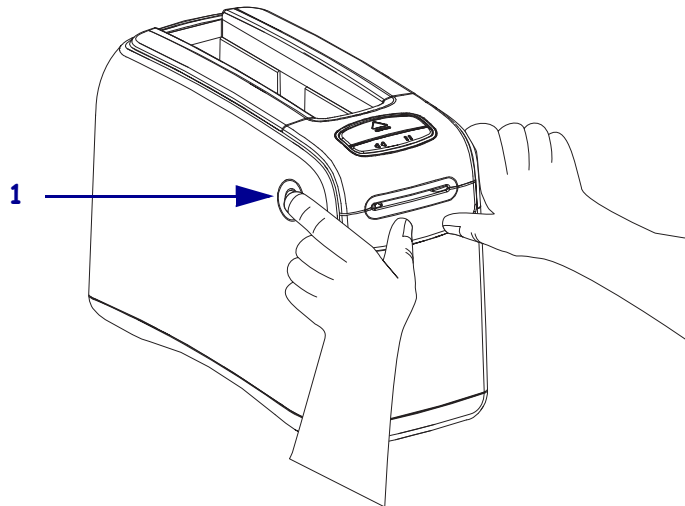

1	Upper cover release button (one on each side)
---	---

5. See [Figure 6](#). Raise the cover up and tilt it toward the back until it is almost resting on the top of the printer.

Figure 6 • HC100 with Cover Open

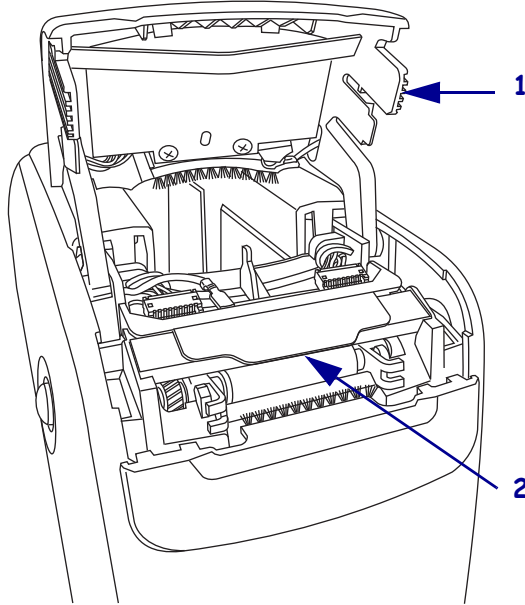

1	Upper cover
2	Metal printhead lever plate

Remove the Printhead Assembly



Caution • Before touching the printhead assembly, discharge any built-up static electricity by touching the metal back plate on the printer near the On/Off switch or by using an antistatic wriststrap and mat.

Caution • Be careful not to touch the printhead with any tools. This could damage the printhead.



Caution • The printhead may be hot and could cause severe burns. Allow the printhead to cool.

1. **Caution** • While performing any tasks near an open printhead, remove all rings, watches, hanging necklaces, identification badges, or other metallic objects that could touch the printhead.
-

See [Figure 6](#). To release the printhead assembly, lift up on the metal printhead lever plate along the front edge of the printhead assembly.

2. See [Figure 7](#). Lift the printhead assembly up and pull it forward ensuring the snap tabs underneath the printhead assembly are disengaged from the printer.

Figure 7 • Close-up of Printhead Assembly Parts

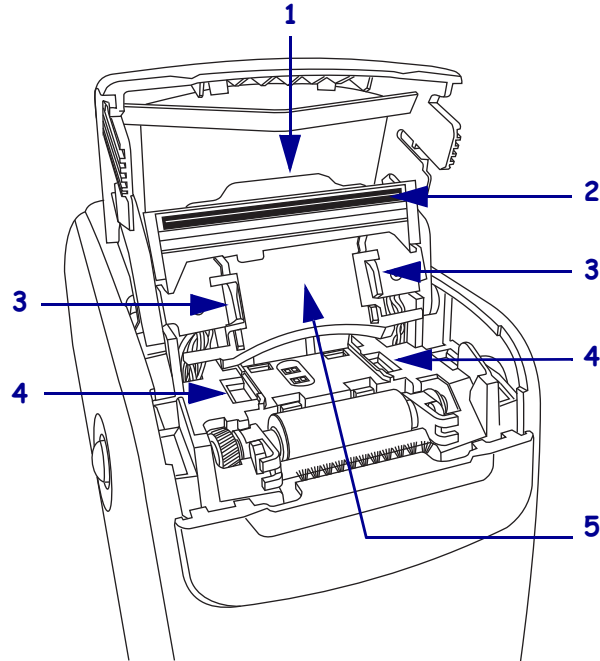

1	Metal printhead lever plate
2	Underside of printhead assembly
3	Snap tabs (2)
4	Chassis slots (2)
5	Media chute

3. See [Figure 8](#). Gently remove all of the wires from the cable clips located at the back outside edges of the printhead assembly.

Figure 8 • Close-Up View of Printhead Assembly

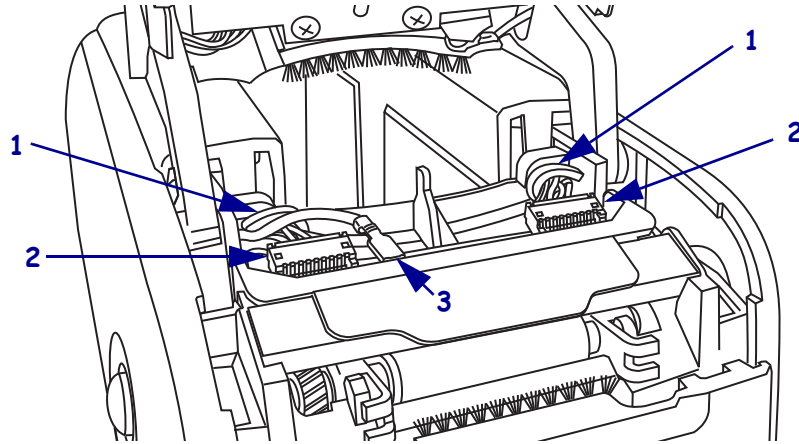

1	Cable clips (2)
2	Printhead assembly socket and connector (2)
3	Ground wire (green)

4. Disconnect the right and left printhead cables.
 - a. Slide a fingernail between the back edge of the socket and the connector to gently pry each side of the connector out.
 - b. Grasp the connector and pull it completely out of the socket.
 - c. Repeat [step 4](#) for the other cable.
5. Disconnect the small green ground wire from the printhead.
6. Remove the printhead assembly and discard.

Install the New Printhead Assembly

Caution • Remove all jewelry that could come into contact with the printhead or other printer parts.

1. See [Figure 8](#). Reconnect the right and left printhead cables.
 - a. Support the front edge of the socket with your fingernail.
 - b. Align the connector with the socket.
 - c. Gently pinch the connector and socket together.
 - d. Repeat [step 1](#) for the other cable.
2. Thread the cable wires through the cable clip on each side of the printhead assembly.
Be sure to include the green ground wire in the cable clip on the left side of the printhead.
3. Reconnect the green ground wire.
4. Clean the print line on the printhead.
 - a. Use the swab from a Preventive Maintenance Kit (part number 47362) or a clean swab dipped in a solution of isopropyl alcohol (minimum 90%) and deionized water (maximum 10%).
 - b. On the underside of the printhead assembly, wipe along the brown strip from end to end.
 - c. Allow the solution to evaporate.
5. See [Figure 7](#). Align the snap tabs on the bottom of the media chute with the slots in the printer chassis.
6. Press the back edge of the printhead assembly into the slots and then press on the metal printhead lever plate to snap the printhead assembly into place.

Resume Operation

1. See [Figure 6](#). To close the upper cover, rock the front edge down, push the cover toward the back of the printer, and then push the cover down.
2. Turn on (I) the printer.
3. Insert the media cartridge into the printer.