









6. Push the media forward until it passes under the printhead assembly (1), under the snap plate (2), and then over the platen roller (3).

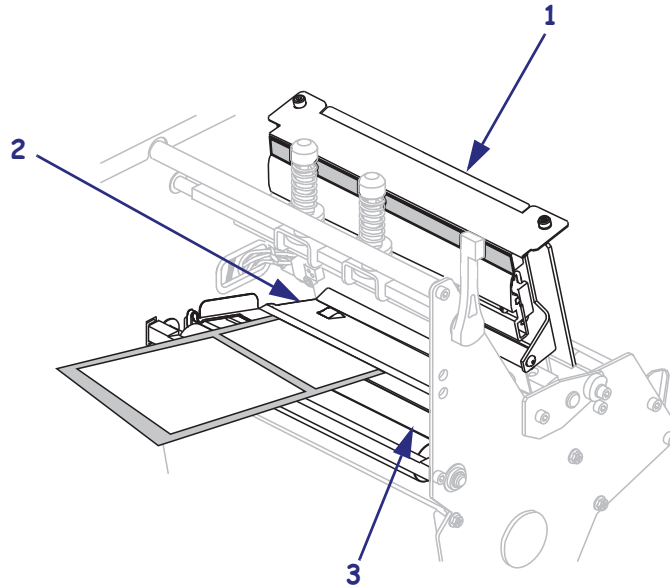

7. In which print mode will your printer be operating? (For more information on print modes, see *Select a Print Mode* on page 51.)

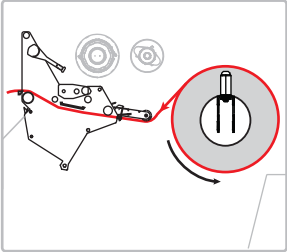
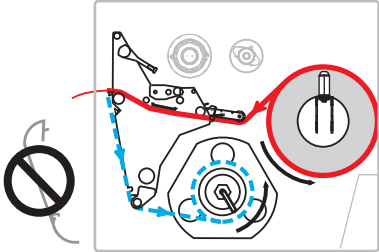
If using...	Then...
<p data-bbox="435 1066 602 1094">Tear-Off mode</p> 	<p data-bbox="1008 1066 1344 1129">Continue with <i>Final Steps for Tear-Off Mode</i> on page 65.</p>
<p data-bbox="435 1386 602 1413">Peel-Off mode</p> 	<p data-bbox="1008 1386 1409 1449">Continue with <i>Final Steps for Peel-Off Mode</i> on page 67.</p>

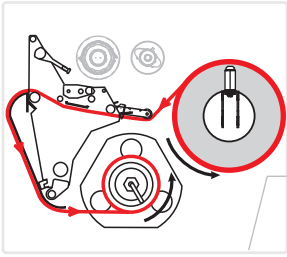
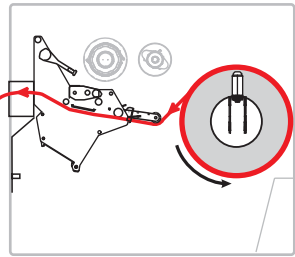
<b>If using...</b>	<b>Then...</b>
<p data-bbox="423 262 597 304"><b>Rewind mode</b></p>  <p>The diagram shows the internal media path of the printer. Red arrows indicate the path of the media from the left side, through a series of rollers and gears, and finally into a large circular spool on the right. The spool is highlighted with a red circle, and a red arrow points into it, indicating the direction of media winding.</p>	<p data-bbox="1000 262 1432 336">Continue with <i>Final Steps for Rewind Mode</i> on page 72.</p>
<p data-bbox="423 577 578 619">Cutter mode</p>  <p>The diagram shows the internal media path of the printer. Red arrows indicate the path of the media from the left side, through a series of rollers and gears, and finally into a large circular spool on the right. The spool is highlighted with a red circle, and a red arrow points into it, indicating the direction of media winding.</p>	<p data-bbox="1000 577 1432 651">Continue with <i>Final Steps for Cutter Mode</i> on page 77.</p>

**Final Steps for Rewind Mode**

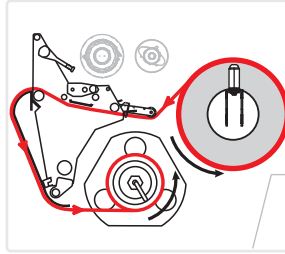

- 8. Remove the rewind plate from its storage location inside the printer.
- 9. Position the rewind plate so that the lip on the attached hook plate points down.

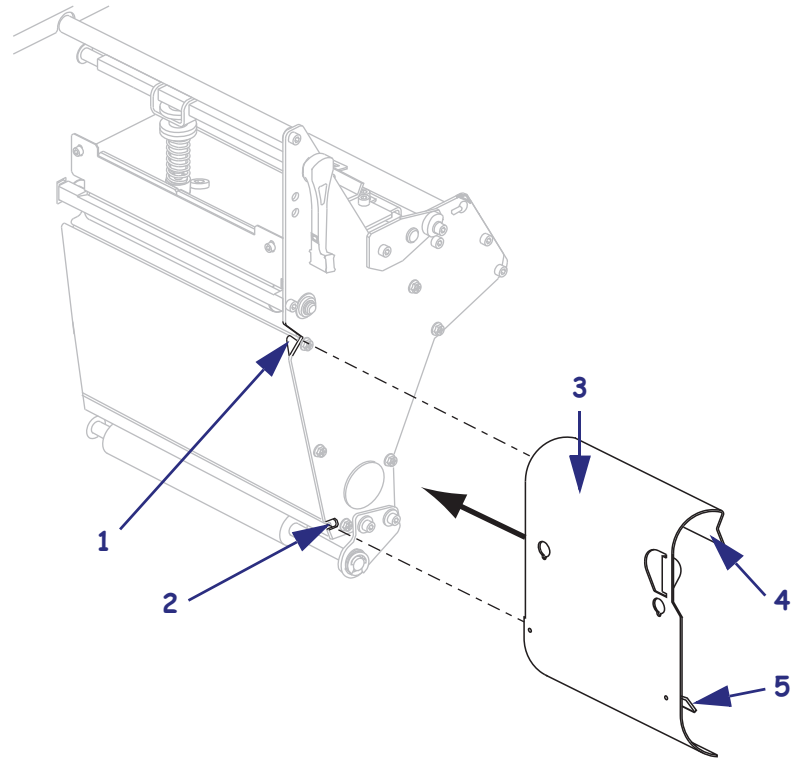

<b>1</b>	Upper slot
<b>2</b>	Lower slot
<b>3</b>	Rewind plate
<b>4</b>	Lip
<b>5</b>	Adjustable hook plate

- 10. Insert the hook plate lip 1/2 in. (13 mm) into the lower slot in the side plate.
- 11. Align the upper end of the rewind plate with the matching upper slot in the side plate.
- 12. Slide in the rewind plate until it stops against the printer's main frame.

13. Extend approximately 36 in. (920 mm) of media out of the printer. Remove and discard the labels from this exposed media.

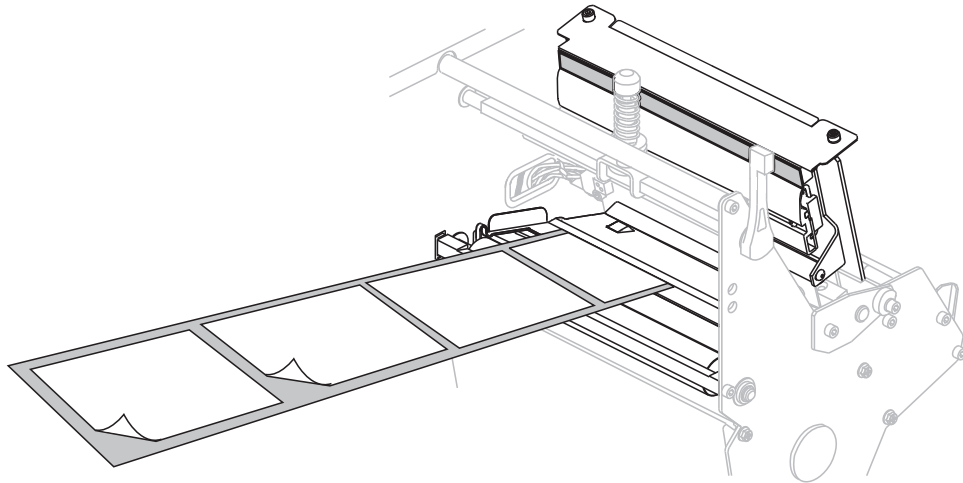

14. Remove the hook from the rewind spindle.

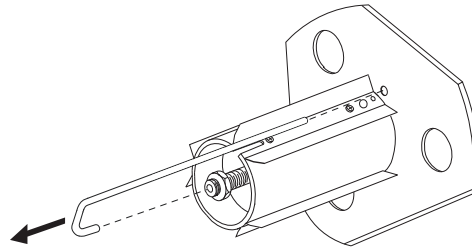

15. If you are using a core, slide it onto the rewind spindle until it is flush against the guide plate.



**Note** • A core is not required.



**16.** Wind the media liner counterclockwise around the rewind spindle.

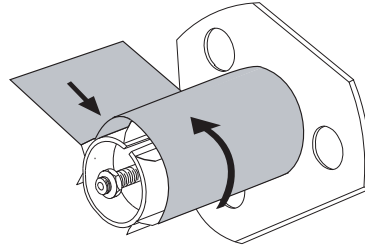

- a.** Reinstall the hook. Insert the short end of the hook into the hole in the center of the adjusting nut (**1**). Insert the long end of the hook into the small hole on the guide plate (**2**).

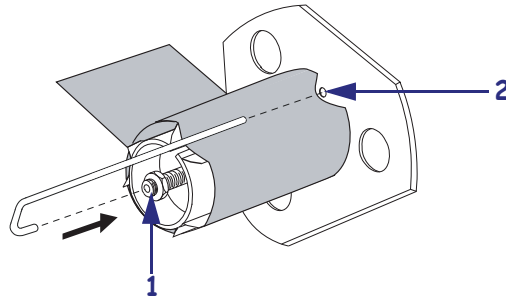

- b.** Rotate the spindle counterclockwise several turns to wind the media liner over the hook and remove any slack.

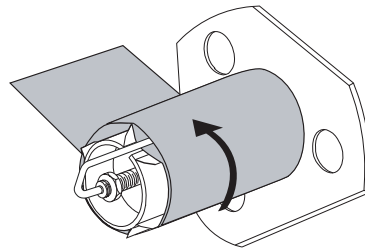

**17.** Align the media with the inner media guide (**1**). Slide in the outer media guide (**2**) until it just touches the edge of the media.

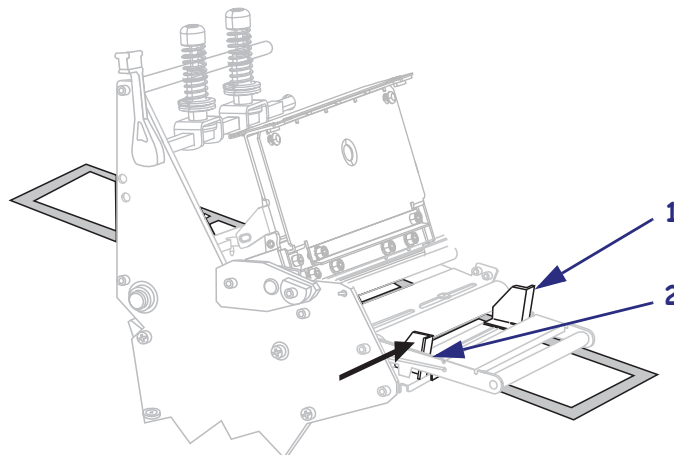

18. Tighten the thumb screw (not visible from this angle) that is located on the bottom of the outer media guide (1).

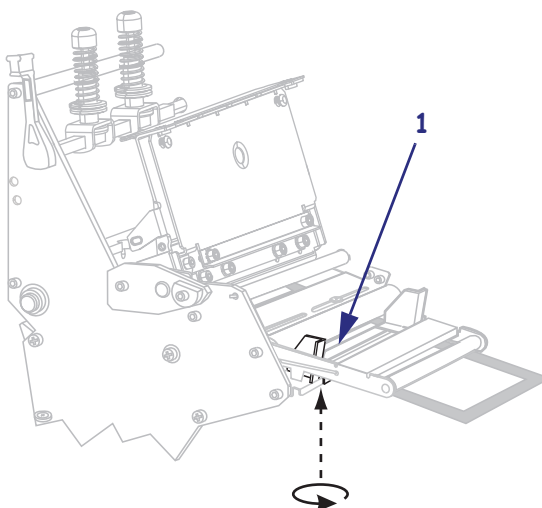

19. Push down the printhead assembly (1), and then rotate the printhead-open lever (2) until it locks into place.

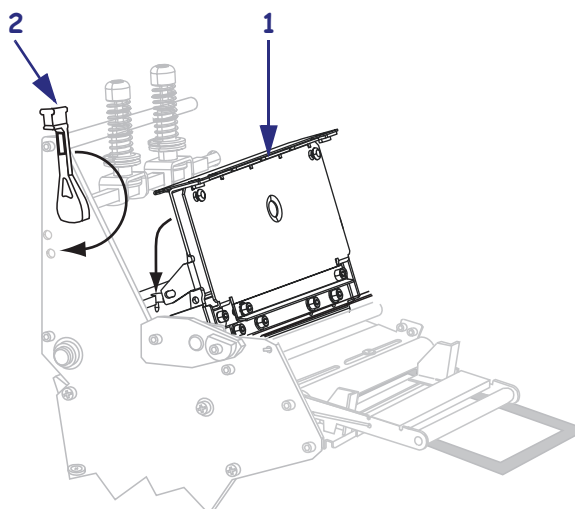

The media winds on the rewind spindle or core.

20. Close the media door.

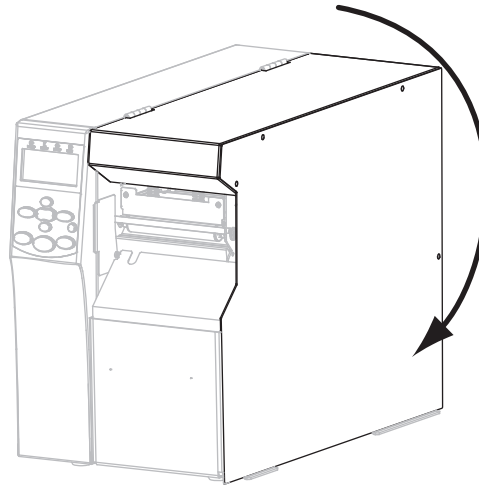

21. Set the printer to Rewind mode.

22. If desired, perform the *CANCEL Self Test* to verify that your printer is able to print.