

Roll Media (Continued)

- c. Place the roll of media on the media supply hanger. Push the roll back as far as it will go.

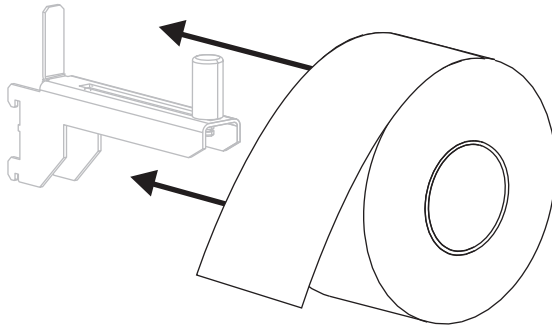

- d. Slide in the media supply guide until it touches the edge of the roll.

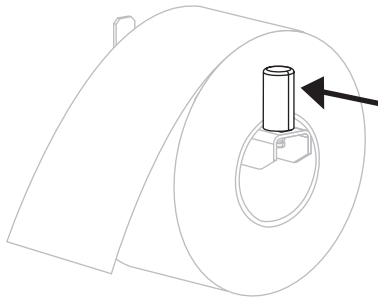

Fanfold Media (Continued)

- c. Drape the media over the media supply hanger.

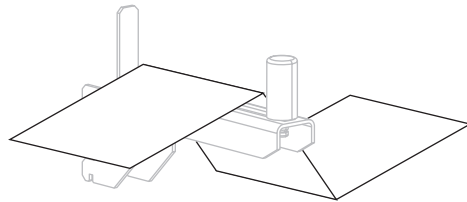

- d. Slide in the media supply guide until it touches the edge of the media.

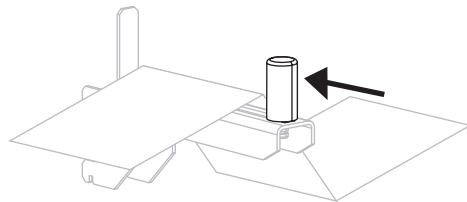

- 5. Thread the media under the media dancer assembly roller (1), the media guide roller (2), and then the upper media sensor (3).



Important • Make sure that you thread the media under these components. If you thread the media over them, the media obstructs the ribbon sensor and causes a false **RIBBON OUT** error.

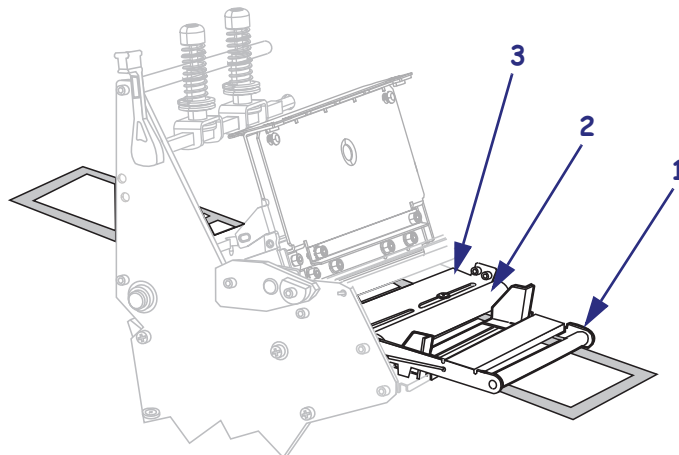

6. Push the media forward until it passes under the printhead assembly (1), under the snap plate (2), and then over the platen roller (3).

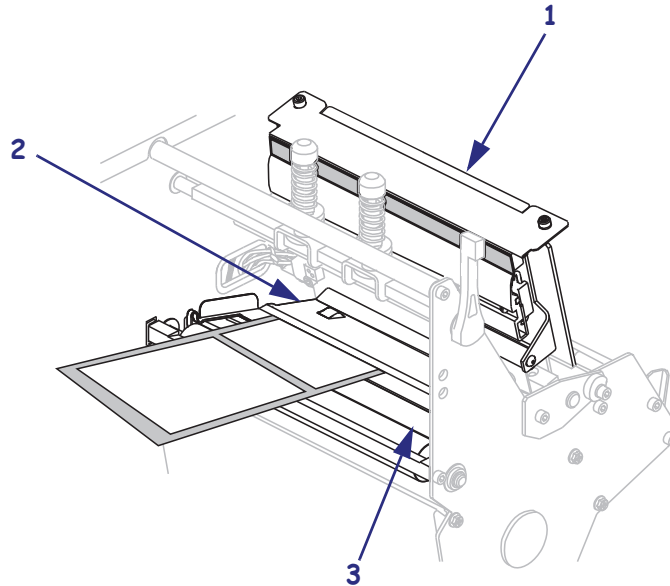

7. In which print mode will your printer be operating? (For more information on print modes, see *Select a Print Mode* on page 51.)

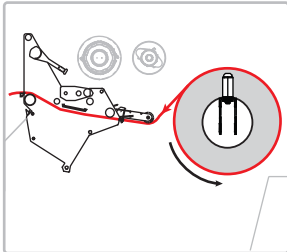
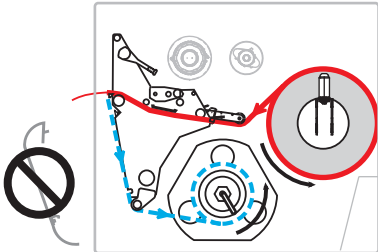
If using...	Then...
<p data-bbox="435 1062 602 1094">Tear-Off mode</p> 	<p data-bbox="1003 1062 1344 1129">Continue with <i>Final Steps for Tear-Off Mode</i> on page 65.</p>
<p data-bbox="435 1381 602 1413">Peel-Off mode</p> 	<p data-bbox="1003 1381 1409 1449">Continue with <i>Final Steps for Peel-Off Mode</i> on page 67.</p>

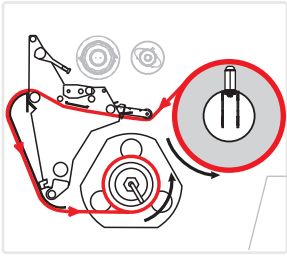
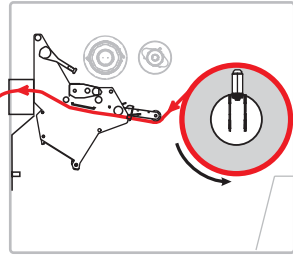
If using...	Then...
<p data-bbox="423 262 592 304">Rewind mode</p>  <p>The diagram shows the internal media path in a printer. Red arrows indicate the path of the media from the left side, through a series of rollers and gears, and finally into a large circular spool on the right. The spool is highlighted with a red circle, and a red arrow points into it, indicating the direction of media loading.</p>	<p data-bbox="1000 262 1339 336">Continue with <i>Final Steps for Rewind Mode</i> on page 72.</p>
<p data-bbox="423 577 581 619">Cutter mode</p>  <p>The diagram shows the internal media path in a printer. Red arrows indicate the path of the media from the left side, through a series of rollers and gears, and finally into a large circular spool on the right. The spool is highlighted with a red circle, and a red arrow points into it, indicating the direction of media loading.</p>	<p data-bbox="1000 577 1412 651">Continue with <i>Final Steps for Cutter Mode</i> on page 77.</p>

Final Steps for Cutter Mode

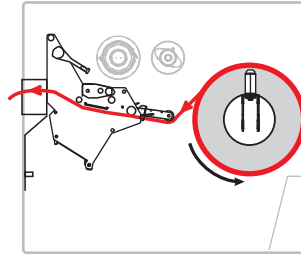

8. **Caution** • The cutter blade is sharp. Do not touch or rub the blade with your fingers.

Thread the media forward until it passes under the printhead assembly (1), under the snap plate (2), and through the cutter assembly (3).

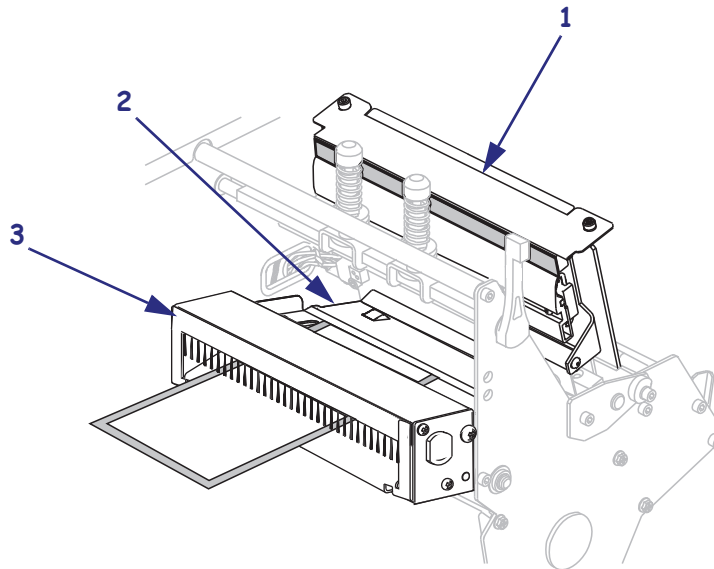

9. Align the media with the inner media guide (1). Slide in the outer media guide (2) until it just touches the edge of the media.

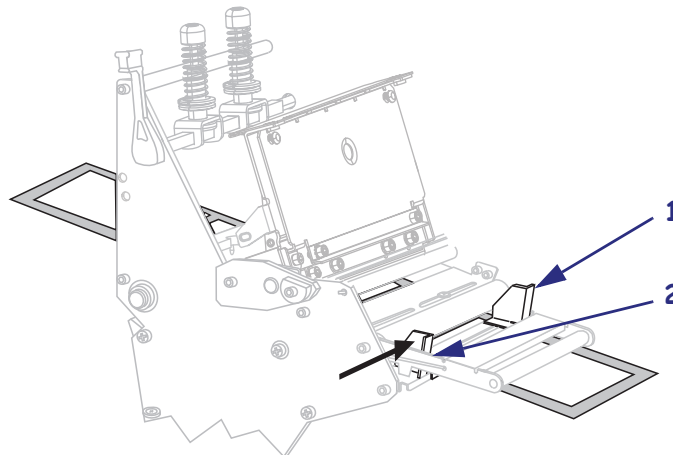

10. Tighten the thumb screw (not visible from this angle) that is located on the bottom of the outer media guide (1).

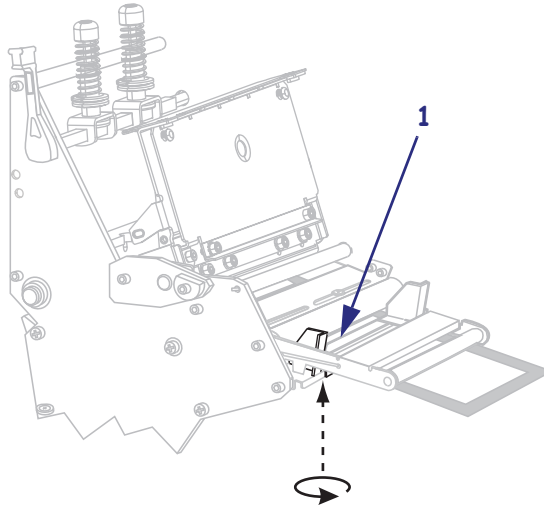

11. Push down the printhead assembly (1), and then rotate the printhead-open lever (2) until it locks into place.

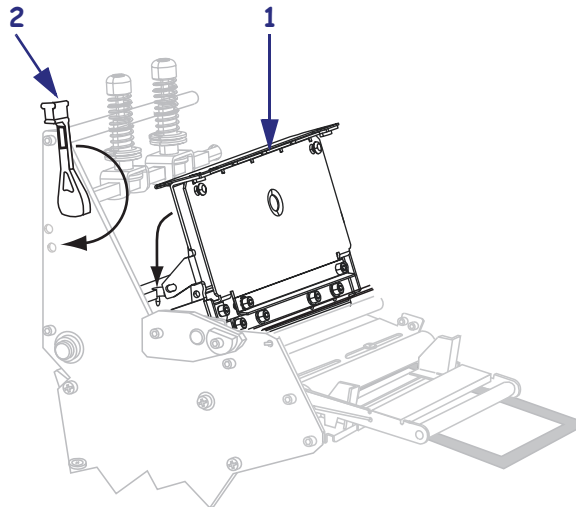

The media winds on the rewind spindle or core.

12. Close the media door.

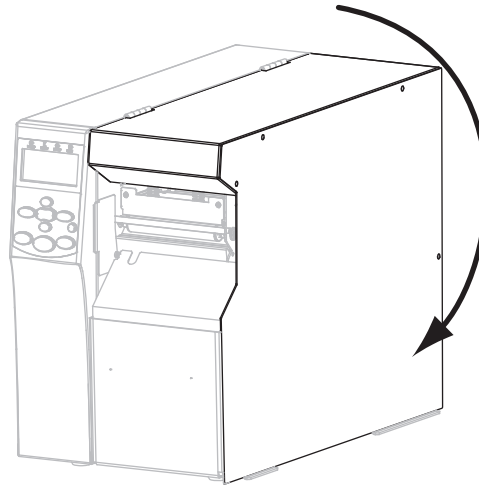

13. Set the printer to Cutter mode.

14. If desired, perform the *CANCEL Self Test* to verify that your printer is able to print.